

SECOND FLOOR PLAN

1/8" = 1'-0"

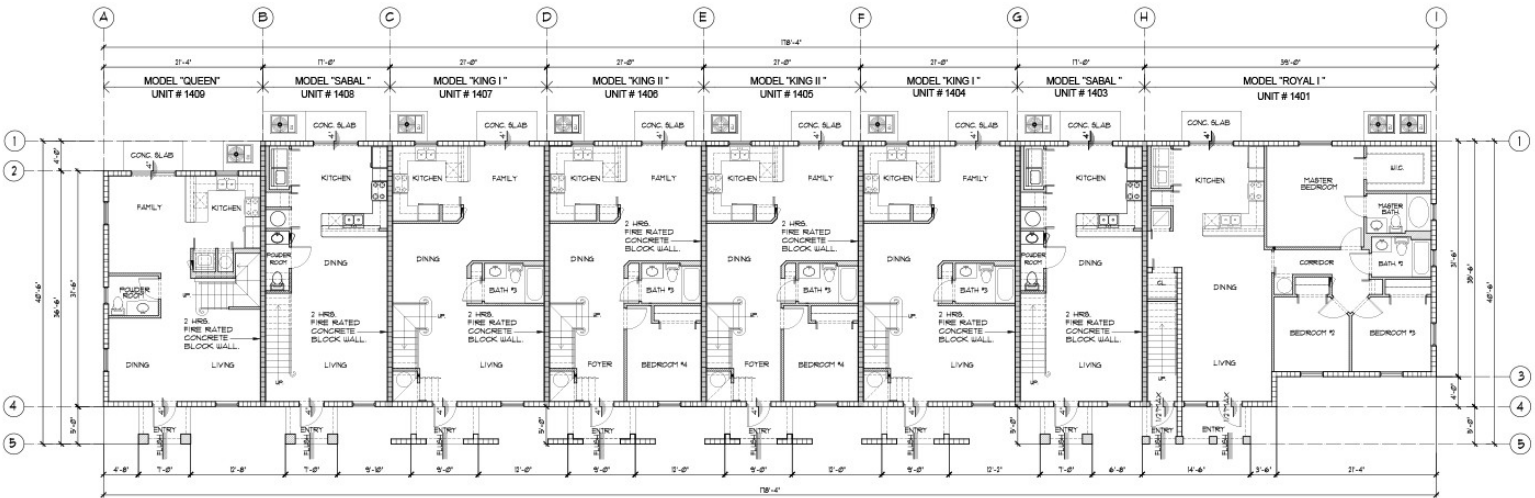

GROUND FLOOR PLAN

1/8" = 1'-0"

BREAKDOWN BUILDING # 14:

MODEL	UNIT #	GROUND FLOOR AREA	2nd FLOOR AREA	TOTAL AREA PER MODEL	UNITS PER BUILDING	TOTAL AREA
'ROYAL I'	1401	1,270 SQ.FT.	N/A	1,270 SQ.FT.	1	1,270 SQ.FT.
'ROYAL I'	1402	N/A	1,328 SQ.FT.	1,328 SQ.FT.	1	1,328 SQ.FT.
'SABAL'	1403-1408	630 SQ.FT.	604 SQ.FT.	1,234 SQ.FT.	2	2,468 SQ.FT.
'KING I'	1404-1407	791 SQ.FT.	746 SQ.FT.	1,537 SQ.FT.	2	3,074 SQ.FT.
'KING I'	1405-1406	791 SQ.FT.	746 SQ.FT.	1,537 SQ.FT.	2	3,074 SQ.FT.
'QUEEN'	1409	707 SQ.FT.	672 SQ.FT.	1,379 SQ.FT.	1	1,379 SQ.FT.
BUILDING # 14:					9	12,611 SQ.FT.

F.B.C. 1-463  
PARKING SPACES AND ACCESSIBLES SHALL BE LEVEL WITH SURFACE SLOPES NOT EXCEEDING 1/50 (2%) IN ALL DIRECTIONS.

F.B.C. 1-425B  
INSTALL DETECTABLE WARNING WHERE PEDESTRIAN ROUTES CROSS OR ADJACENT VEHICULAR TRAFFIC AREAS

ALL CHANGES IN LEVELS ALONG AN ACCESSIBLE ROUTE SHALL NOT VARY BY MORE THAN 1/2"

F.B.C. R4409.13.5  
TERMITE PROTECTION

ALL BUILDINGS SHALL HAVE A PRE-CONSTRUCTION TREATMENT PROTECTION AGAINST SUBTERRANEAN TERMITES. THE RULES AND LAWS AS ESTABLISHED BY THE FLORIDA DEPARTMENT OF AGRICULTURE AND CONSUMER SERVICES SHALL BE DEEMED AS APPROVED WITH RESPECT TO PRE-CONSTRUCTION SOIL TREATMENT FOR PROTECTION AGAINST SUBTERRANEAN TERMITES. A CERTIFICATE OF COMPLIANCE SHALL BE ISSUED TO THE BUILDING DEPARTMENT BY THE LICENSED PEST CONTROL COMPANY THAT CONTAINS THE FOLLOWING STATEMENT: "THE BUILDING HAS RECEIVED A COMPLETE TREATMENT FOR THE PREVENTION OF SUBTERRANEAN TERMITES TREATMENT IS IN ACCORDANCE WITH RULES AND LAWS ESTABLISHED BY THE FLORIDA DEPARTMENT OF AGRICULTURE AND CONSUMER SERVICES."

WALL PENETRATION NOTE:

NO PENETRATIONS ALLOWED THRU PARTY WALLS. ALL ELECTRICAL, PLUMBING AND A/C SHALL BE INSTALLED IN A DOUBLED PURRED SYSTEM (DOUBLE FURR SYSTEM 2-1/2" FT. U.D.)



SEE SITE PLAN FOR EXACT LOCATION

NOTE: SEE EACH INDIVIDUAL MODEL FOR ADDITIONAL INFORMATION

BUILDING # 14  
(9 UNITS)

REVISIONS	BY

OCTAVIO A. SANTURIO A.I.A.  
ARCHITECT  
16362 W. BAYVIEW BLVD. SUITE 100  
TALLahas, FL 32310  
TEL: (904) 869-8844 / (866)-886-6106 FAX: (904) 869-7143  
FL. ARCH. #00079719

OWNERS:  
GREG HOMES VI, LLC  
180 SULLY AVENUE  
FLORIDA CITY, FLORIDA 33034  
PHONE: (305) 2-45-9192

"KEYS ISLES"  
TOWNHOMES  
FLORIDA CITY, FLORIDA

THIS DRAWING AND SPECIFICATION CONTAINS INFORMATION PROPRIETARY TO OCTAVIO A. SANTURIO ARCHITECT AND ARE THE PROPERTY OF OCTAVIO A. SANTURIO ARCHITECT. NO REPRODUCTION OR TRANSMISSION OF ANY KIND IS PERMITTED WITHOUT THE WRITTEN PERMISSION OF OCTAVIO A. SANTURIO ARCHITECT.

DRAWN BY: JOHN D. GARDNER  
CHECKED BY: G.A.B.  
DATE: OCTOBER 2021  
SCALE: AS SHOWN  
JOB NO: 2106  
SHEET

AB-1  
11 OF 31 SHEETS